

U 4.40

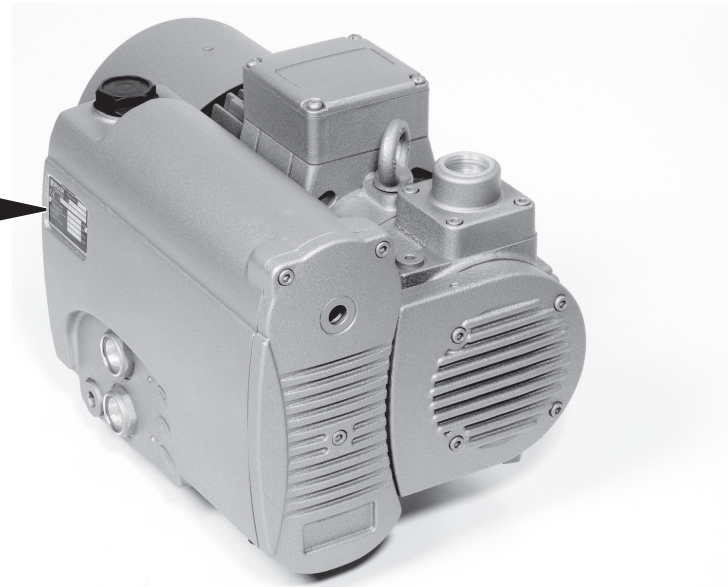
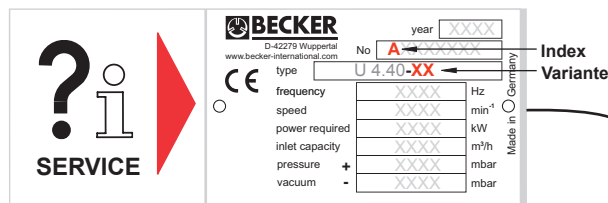
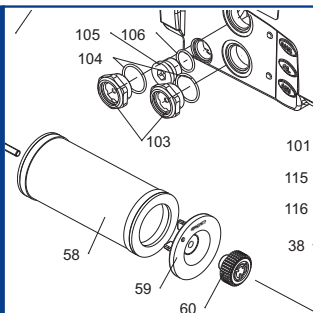

Ersatzteilliste
Spare parts list
Liste de pièces de rechange
Listino pezzi di ricambio
Lista de piezas de recambio
Lista de peças sobresselentes
Reserveonderdelenlijst
Atsarginių dalių sąrašas
Varuosad nimekirja
Rezerves daļu saraksts

Reservedelsliste
Reservdelslista
Varaosuettelo
Reservedelsliste
Wykaz części zamiennych
Tartalékalkatrész lista
Seznam náhradních dílů
Seznam nadomestnih delov
Zoznam náhradných dielov
Rezervni dijelovi popis

Lista pieselor de schimb
Páirteanna spártha liosta
Κατάλογος ανταλλακτικών
Yedek parça listesi
Списък на резервните части
Перечень запасных частей
スペアパーツリスト
예비 부품 목록
备用零件目录

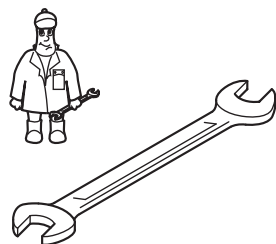

Pos.	Menge ²⁾ Quantity Quantité Quantità Cantidad	Bestell-Nr. Ident No. No. Identification No. Identificazione No. de pedido	Bezeichnung Description Designation Designazione Descripción
□	1	549000 40500	Dichtungssatz, Complete set of seals, Jeu de joints, Kit di guarnizioni, Junta Completa
7	SATZ/KIT	900585 00003	Schieber, Rotor Vane, Palette, Empujador
58	1	965414 00000	Luftentölelement, Oil separating element, Element separation huile, Cartuccia sepa-ratore olio, Elemento de desaceitar de aire

²⁾ erforderliche Bestellmenge / necessary order quantity / quantité nécessaire / quantità di ordinazione necessari / cantidad necesario

Wartung
Maintenance
Entretien
Manutenzione
Mantenimiento



U 4.40

Standard



Variante



U 4.40/XX

①

/09

- mit Gasballastventil
- with gas ballast valve
- avec l'este d'air
- con valvola di zavoratrice
- con valvula de lastre de gas

② ③

/0-25 + /0-56

- mit Öl-Wasser-Kühler
- with oil-to-water heat exchanger
- avec réfrigérant à l'huile et à l'eau
- con radiatore ad olio - acqua
- con refrigerador aceite-agua

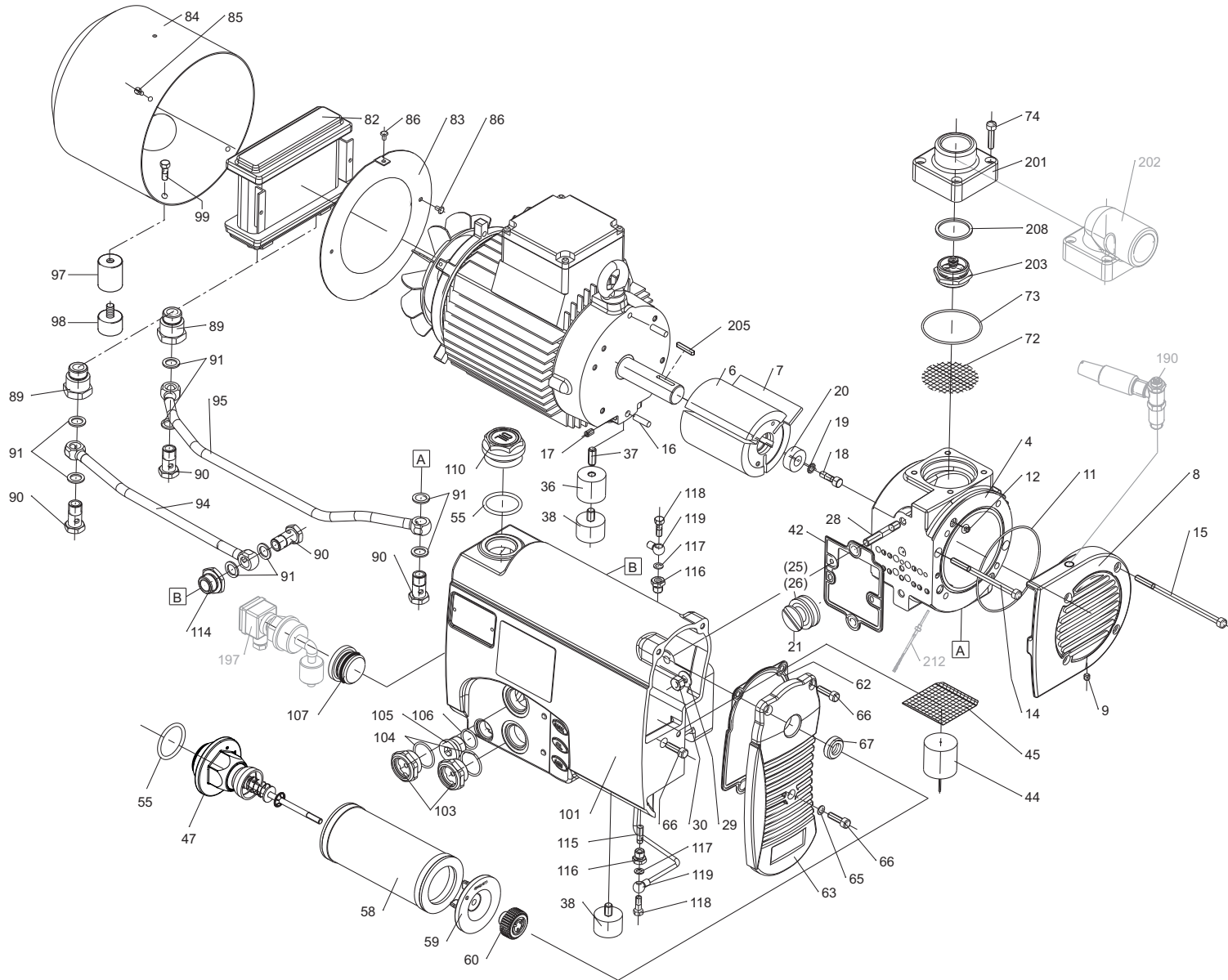

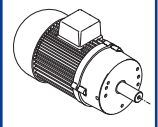

SERVICE ?



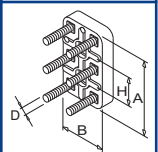
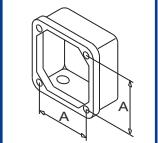
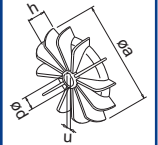
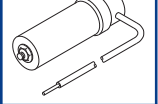

C = ? μ F
U = ? V



A INDEX	Pos.	Bestell Nr.	Beschreibung	
U 4.40	□	549000 40500	DICHTUNGSSATZ ¹⁾	
	4	500102 40500	GEHÄUSE, KOMPLETT	
	6	020000 40500	KOLBEN	
	7	900585 00003	SCHIEBER (SATZ) ²⁾	
	8	000701 40500	SEITENDECKEL	
	9	945618 00000	GEWINDESTIFT	
	14	945373 00000	INNENSECHSKANTSCHRAUBE	
	15	945374 00000	INNENSECHSKANTSCHRAUBE	
	16	947628 01000	ZYLINDERSTIFT	
	17	945801 01000	GEWINDESTIFT	
	18	901807 00000	WELLENENDSCHRAUBE	
	19	949203 00000	ZAHNSCHEIBE	
	20	016800 05000	SPANNSCHEIBE	
	21	537500 26200	VENTIL, KOMPL.	
	28	946917 00000	STIFTSCHRAUBE	
	29	917107 00000	TELLERFEDER	
	30	947105 00000	SECHSKANTMUTTER	
	36	068101 40500	ZWISCHENSTÜCK	
	37	945634 00000	GEWINDESTIFT	
	38	741310 60000	GUMMIPUFFER	
	44	867800 99559	SCHWIMMER	
45	005001 40300	SIEB		
47	727503 99628	ABBLASEVENTIL		
58	965414 00000	LUFTENTÖLELEMENT (1x) ²⁾		
59	016802 40300	SPANNSCHEIBE		
60	921500 50000	HANDGRIFF		
63	003700 40500	DECKEL		
66	945320 00000	INNENSECHSKANTSCHRAUBE		
67	953116 00000	DÜSE		
72	005000 40500	SIEB		
74	945321 00000	INNENSECHSKANTSCHRAUBE		
82	960201 40500	KÜHLER		
83	917800 40500	HALTERRING		
84	960700 40500	LÜFTERHAUBE		
85	946308 00000	ZYLINDERSCHRAUBE		
86	948750 00000	BLINDNIET		
89	912317 00000	ANSCHLUSS-SCHRAUBE		
90	948407 00000	HOHLSCHRAUBE		
94	012203 40500	LEITUNG		
95	012204 40500	LEITUNG		
97	068100 40300	STÜTZE		
98	741310 80000	GUMMIPUFFER		
99	945218 00000	SECHSKANTSCHRAUBE		
101	002402 40500	ÖLABSCHEIDERGEHÄUSE		
103	907309 00000	ÖLSCHAUGLAS		
105	951219 00000	VERSCHLUSS-SCHRAUBE		
107	951221 00100	VERSCHLUSS-SCHRAUBE		
110	916800 10000	SCHRAUBDECKEL		
114	912318 00000	ANSCHLUSS-SCHRAUBE		
115	003300 10700	DÜSE		
116	912300 00000	ANSCHLUSS-SCHRAUBE		
118	009400 19000	KUGELSTÜCKSCHRAUBE		
119	012200 40300	LEITUNG		
197	741103 99682	NIVEAUGEBER - OPTIONAL		
201	007801 40500	GEWINDEFLANSCH - STANDARD		
202	007802 40500	GEWINDEFLANSCH 90° - OPTIONAL		
203	537506 99633	RÜCKSCHLAGVENTIL		
205	947701 00000	PASSFEDER		
212	943402 60000	TEMPERATURFÜHLER PT100 - OPTIONAL		

A INDEX	Pos.	Bestell Nr.	Beschreibung	
		960009 00000 960016 00100 960023 00100	BECKER LUBE M 100 (MINERALÖL) - 1L BECKER LUBE S 100 (SYNTHETIKÖL) - 1L BECKER LUBE SL 100 (LEBENSMITTELBEREICH) - 1L	
¹⁾ Dichtungssatz - 549000 40500 - Pos.: 11, 12, 25, 26, 42, 55, 62, 65, 73, 91, 104, 106, 117, 147, 208				
²⁾ erforderliche Bestellmenge / Wartung				

A INDEX	Pos.	Ident No.	Description	
U 4.40	□	549000 40500	SET OF SEALS ¹⁾	
	4	500102 40500	PUMP BODY	
	6	020000 40500	ROTOR	
	7	900585 00003	VANES (KIT) ²⁾	
	8	000701 40500	LID	
	9	945618 00000	THREADED PIN	
	14	945373 00000	SOCKET HEAD SCREW	
	15	945374 00000	SOCKET HEAD SCREW	
	16	947628 01000	STRAIGHT PIN	
	17	945801 01000	THREADED PIN	
	18	901807 00000	SCREW	
	19	949203 00000	TOOTHED SPRING WASHER	
	20	016800 05000	CLAMPING DISC	
	21	537500 26200	VALVE	
	28	946917 00000	STUD	
	29	917107 00000	CUP SPRING	
	30	947105 00000	HEX.NUT	
	36	068101 40500	FLANGES	
	37	945634 00000	THREADED PIN	
	38	741310 60000	RUBBER BUFFER	
	44	867800 99559	FLOAT	
45	005001 40300	SIEVE		
47	727503 99628	BLOW-OFF VALVE		
58	965414 00000	OIL SEPARATING ELEMENT (1x) ²⁾		
59	016802 40300	CLAMPING DISC		
60	921500 50000	HANDLE		
63	003700 40500	COVER		
66	945320 00000	SOCKET HEAD SCREW		
67	953116 00000	NOZZLE		
72	005000 40500	METAL FILTER		
74	945321 00000	SOCKET HEAD SCREW		
82	960201 40500	COOLER		
83	917800 40500	RETAINING RING		
84	960700 40500	VENTILATOR HOOD		
85	946308 00000	CYLINDER SCREW		
86	948750 00000	BLIND RIVET		
89	912317 00000	CONNECTING SCREW		
90	948407 00000	HOLLOW SCREW		
94	012203 40500	PIPE		
95	012204 40500	PIPE		
97	068100 40300	SUPPORT PILLAR		
98	741310 80000	RUBBER BUFFER		
99	945218 00000	HEX. HEAD SCREW		
101	002402 40500	HOUSING FOR OIL SEPARATOR		
103	907309 00000	OIL SIGHT GLASS		
105	951219 00000	LOCKING SCREW		
107	951221 00100	LOCKING SCREW		
110	916800 10000	COVER		
114	912318 00000	CONNECTING SCREW		
115	003300 10700	NOZZLE		
116	912300 00000	CONNECTING SCREW		
118	009400 19000	HOLLOW HOLDING SCREW		
119	012200 40300	PIPE		
197	741103 99682	OIL LEVEL CONTROL - OPTIONAL		
201	007801 40500	SCREWED FLANGE - STANDARD		
202	007802 40500	SCREWED FLANGE 90° - OPTIONAL		
203	537506 99633	NON RETURN VALVE		
205	947701 00000	KEY		
212	943402 60000	TEMPERATURE SENSOR - OPTIONAL		

A INDEX	Pos.	Ident No.	Description	
		960009 00000 960016 00100 960023 00100	BECKER LUBE M 100 (MINERAL OIL) - 1L BECKER LUBE S 100 (SYNTHETIC OIL) - 1L BECKER LUBE SL 100 (FOOD SECTOR) - 1L	
¹⁾ Set of seals - 549000 40500 - Pos.: 11, 12, 25, 26, 42, 55, 62, 65, 73, 91, 104, 106, 117, 147, 208				
²⁾ necessary order quantity / maintenance				



A INDICE	Pos.	No. Identification	Designation
U 4.40	□	549000 40500	JEU DE JOINTS ¹⁾
	4	500102 40500	CARCASSE
	6	020000 40500	PISTON
	7	900585 00003	PALETTES (KIT) ²⁾
	8	000701 40500	COUVERCLE
	9	945618 00000	GOUPILLE FILETEE
	14	945373 00000	VIS HEXAGONALE INTERNE
	15	945374 00000	VIS HEXAGONALE INTERNE
	16	947628 01000	GOUPILLE CYLINDRIQUE
	17	945801 01000	GOUPILLE FILETEE
	18	901807 00000	VIS
	19	949203 00000	DENT DISQUE
	20	016800 05000	DISQUE DE SERRAGE
	21	537500 26200	SOUPAPE
	28	946917 00000	PRISONNIER
	29	917107 00000	RESSORT BELLEVILLE
	30	947105 00000	ECROU A 6 PANS
	36	068101 40500	BRIDES
	37	945634 00000	GOUPILLE FILETEE
	38	741310 60000	AMORTISSEUR EN CAOUTCHOUC
	44	867800 99559	PIED CAOUTCHOVE
45	005001 40300	FILTRE	
47	727503 99628	SILENCIEUX	
58	965414 00000	ELEMENT SEPARATION HUILE (1x) ²⁾	
59	016802 40300	DISQUE DE SERRAGE	
60	921500 50000	POIGNEE	
63	003700 40500	COUVERCLE	
66	945320 00000	VIS HEXAGONALE INTERNE	
67	953116 00000	BUSE	
72	005000 40500	FILTRE EN METAL	
74	945321 00000	VIS HEXAGONALE INTERNE	
82	960201 40500	REFROIDISSEUR	
83	917800 40500	BAGUE DE MAINTIENT	
84	960700 40500	CARTER DE VENTILATEUR	
85	946308 00000	TETE A VIS CYLINDRIQUE	
86	948750 00000	RIVET AVEUGLIE	
89	912317 00000	VIS DE RACCORD	
90	948407 00000	VIS CREUSE	
94	012203 40500	TUYAU	
95	012204 40500	TUYAU	
97	068100 40300	SUPPORT INTERMEDIAIRE	
98	741310 80000	AMORTISSEUR EN CAOUTCHOUC	
99	945218 00000	VIS HEXAGONALE	
101	002402 40500	CORP DE SEPARATEUR D'HUILE	
103	907309 00000	VERRE REGARD	
105	951219 00000	BOUCHON	
107	951221 00100	BOUCHON	
110	916800 10000	COUVERCLE	
114	912318 00000	VIS DE RACCORD	
115	003300 10700	GICLEUR	
116	912300 00000	VIS DE RACCORD	
118	009400 19000	VIS CREUSE DE FIXATION	
119	012200 40300	TUYAU	
197	741103 99682	INDICATEUR DE NIVEAU - EN OPTION	
201	007801 40500	BRIDE FILETEE - STANDARD	
202	007802 40500	BRIDE FILETEE 90° - EN OPTION	
203	537506 99633	SOUPAPE ANTI-RETOUR	
205	947701 00000	CLAVETTE	
212	943402 60000	SONDE DE TEMPERATURE - EN OPTION	







A INDICE	Pos.	No. Identification	Designation
		960009 00000 960016 00100 960023 00100	BECKER LUBE M 100 (HUILE MINÉRALE) - 1L BECKER LUBE S 100 (L'HUILE SYNTHÉTIQUE) - 1L BECKER LUBE SL 100 (SECTEUR DE L'ALIMENTATION) - 1L
¹⁾ Jeu de joints - 549000 40500 - Pos.: 11, 12, 25, 26, 42, 55, 62, 65, 73, 91, 104, 106, 117, 147, 208 ²⁾ quantité nécessaire / entretien			

A INDICE	Pos.	No. Identificazione	Designazione
U 4.40	□	549000 40500	SERIE DI GUARNIZIONE ¹⁾
	4	500102 40500	CARCASSA
	6	020000 40500	ROTORE
	7	900585 00003	PALETTE (KIT) ²⁾
	8	000701 40500	COPERCHIO
	9	945618 00000	SPINA FILETTATURA
	14	945373 00000	VITE ESAGONALE INTERNA
	15	945374 00000	VITE ESAGONALE INTERNA
	16	947628 01000	PERNO
	17	945801 01000	SPINA FILETTOTA
	18	901807 00000	VITE
	19	949203 00000	DISCO A DENTE
	20	016800 05000	DISCO DI FISSAGGIO
	21	537500 26200	VALVOLA
	28	946917 00000	L'ASTA A VITE
	29	917107 00000	MOLLA A DISCO
	30	947105 00000	DADO ESAGONALE
	36	068101 40500	FLANGE
	37	945634 00000	SPINA FILETTATURA
	38	741310 60000	AMMORTIZZATORE IN GOMMA
	44	867800 99559	GALLEGGIANTE
45	005001 40300	FILTRO	
47	727503 99628	SILENZIATORE	
58	965414 00000	CARTUCCIA SEPARATORE OLIO (1x) ²⁾	
59	016802 40300	DISCO DI FISSAGGIO	
60	921500 50000	MANETTA	
63	003700 40500	COPERCHIO	
66	945320 00000	VITE ESAGONALE INTERNA	
67	953116 00000	UGGELLO	
72	005000 40500	FILTRO METALLICO	
74	945321 00000	VITE ESAGONALE INTERNA	
82	960201 40500	RAFREDDATORE	
83	917800 40500	ANELLO PORTANTE	
84	960700 40500	CARTER DEL VENTILATORE	
85	946308 00000	VITE A TESTA CILINDRICA	
86	948750 00000	RIVETTO CIECO	
89	912317 00000	ATTACO FILETTATO	
90	948407 00000	VITE ESAGONALE	
94	012203 40500	CONDOTTO	
95	012204 40500	CONDOTTO	
97	068100 40300	SUPPORTO	
98	741310 80000	AMMORTIZZATORE IN GOMMA	
99	945218 00000	VITE ESAGONALE	
101	002402 40500	CARCASSA SEPARAZIONE OLIO	
103	907309 00000	SPIA LIVELLO OLIO	
105	951219 00000	VITE DI CHIUSURA	
107	951221 00100	VITE DI CHIUSURA	
110	916800 10000	COPERCHIO	
114	912318 00000	ATTACO FILETTATO	
115	003300 10700	UGELLO	
116	912300 00000	ATTACO FILETTATO	
118	009400 19000	VITE PASSAGGIO OLIO	
119	012200 40300	CONDOTTO	
197	741103 99682	SONDA D'OLIO - OPTIONALE	
201	007801 40500	FILANGIA - GILETTATA	
202	007802 40500	FILANGIA 90° - OPTIONALE	
203	537506 99633	VALVOLA NON RITORNO	
205	947701 00000	CHIAVETTA	
212	943402 60000	SONDA TERMICA - OPTIONALE	

A INDICE	Pos.	No. Identificazione	Designazione
		960009 00000 960016 00100 960023 00100	BECKER LUBE M 100 (OLIO MINERALE) - 1L BECKER LUBE S 100 (OLIO SINTETICO) - 1L BECKER LUBE SL 100 (SETTORE ALIMENTARE) - 1L
¹⁾ Serie di guarnizione - 549000 40500 - Pos.: 11, 12, 25, 26, 42, 55, 62, 65, 73, 91, 104, 106, 117, 147, 208 ²⁾ quantità di ordinazione necessari / manutenzione			

A INDICE	Pos.	No. De pedido	Descripción	
U 4.40	□	549000 40500	JUNTA COMPLETA ¹⁾	
	4	500102 40500	CARCASA	
	6	020000 40500	ÉMBOLO	
	7	900585 00003	EMPUJADOR (KIT) ²⁾	
	8	000701 40500	TAPA LATERAL	
	9	945618 00000	VARILLA ROSCADA	
	14	945373 00000	TORNILLO HEXAGONAL INTERIOR	
	15	945374 00000	TORNILLO HEXAGONAL INTERIOR	
	16	947628 01000	PASADOR CILÍNDRICO	
	17	945801 01000	VARILLA ROSCADA	
	18	901807 00000	TORNILLO TERMINAL DE ÁRBOL	
	19	949203 00000	POLEA DENTADA	
	20	016800 05000	ARANDELA TENSORA	
	21	537500 26200	VÁLVULA COMPLETA	
	28	946917 00000	ESPÁRRAGO	
	29	917107 00000	MUELLE DE DISCO	
	30	947105 00000	TUERCA HEXAGONAL	
	36	068101 40500	APOYO	
	37	945634 00000	VARILLA ROSCADA	
	38	741310 60000	AMORTIGUADOR DE GOMA	
	44	867800 99559	FLOTADOR	
45	005001 40300	CRIBA		
47	727503 99628	VÁLVULA DE BARRIDO		
58	965414 00000	ELEMENTO DE DESACEITAR DE AIRE (1x) ²⁾		
59	016802 40300	ARANDELA TENSORA		
60	921500 50000	EMPUÑADURA		
63	003700 40500	TAPA		
66	945320 00000	TORNILLO HEXAGONAL INTERIOR		
67	953116 00000	TOBERA DE SILENCIADOR ACÚSTICO		
72	005000 40500	CRIBA		
74	945321 00000	TORNILLO HEXAGONAL INTERIOR		
82	960201 40500	REFRIGERADOR		
83	917800 40500	CHAPA LATERAL		
84	960700 40500	CAPERUZA DE VENTILADOR		
85	946308 00000	TORNILLO CILÍNDRICO		
86	948750 00000	REMACHE CIEGO		
89	912317 00000	TORNILLO DE EMPALME		
90	948407 00000	TORNILLO HUECO		
94	012203 40500	CONDUCTO		
95	012204 40500	CONDUCTO		
97	068100 40300	APOYO		
98	741310 80000	AMORTIGUADOR DE GOMA		
99	945218 00000	TORNILLO HEXAGONAL		
101	002402 40500	CARCASA DE SEPARADOR DE ACEITE		
103	907309 00000	CRISTAL MIRILLA DE ACEITE		
105	951219 00000	TORNILLO DE CIERRE		
107	951221 00100	TORNILLO DE CIERRE		
110	916800 10000	TAPA ROSCADA		
114	912318 00000	TORNILLO DE EMPALME		
115	003300 10700	TOBERA		
116	912300 00000	TORNILLO DE EMPALME		
118	009400 19000	TORNILLO DE PIEZA ESFÉRICA		
119	012200 40300	CONDUCTO		
197	741103 99682	GENERADOR DE NIVEL - OPCIONAL		
201	007801 40500	BRIDA ROSCADA - STANDARD		
202	007802 40500	BRIDA ROSCADA 90° - OPCIONAL		
203	537506 99633	VÁLVULA ANTIRRETORNO		
205	947701 00000	CHAVETA		
212	943402 60000	ELEMENTO TÉRMICO - OPCIONAL		

A INDICE	Pos.	No. De pedido	Descripción	
		960009 00000 960016 00100 960023 00100	BECKER LUBE M 100 (ACEITE MINERAL) - 1L BECKER LUBE S 100 (ACEITE SINTÉTICO) - 1L BECKER LUBE SL 100 (SECTOR ALIMENTARIO) - 1L	
¹⁾ Junta completa - 549000 40500 - Pos.: 11, 12, 25, 26, 42, 55, 62, 65, 73, 91, 104, 106, 117, 147, 208				
²⁾ cantidad necesario / mantenimiento				

U 4.40	Variante 	Pos. ²⁾	Bestell Nr. / Ident No. / No. Identification / No. Identificazione / No. De pedido		Beschreibung / Description / Designation / Designazione / Desripcion
			  	  	
① /09 - mit Gasballastventil - with gas ballast valve - avec l'este d'air - con valvola di zavoratrice - con valvula de lastre de gas		8	000702 40500	000701 40500	SEITENDECKEL / LID / COUVERCLE / COPERCHIO / TAPA LATERAL
		190	768717 99626		GASBALLASTVENTIL / GAS BALLAST VALVE / L'ESTE D'AIR / VALVOLA DI ZAVORATRICE / VÁLVULA DE LASTRE DE GAS
② ③ /0-25 + /0-56 - mit Öl-Wasser-Kühler - with oil-to-water heat exchanger - avec réfrigérant à l'huile et à l'eau - con radiatore ad olio - acqua - con refrigerador aceite-agua		82		960201 40500	KÜHLER / COOLER / REFROIDISSEUR / RAFREDDATORE / REFRIGERADOR
		83		917800 40500	HALTERRING / RETAINING RING / BAGUE DE MAINTIENT / ANELLO PORTANTE / CHAPA LATERAL
		84	460700 40500	960700 40500	LÜFTERHAUBE / VENTILATOR HOOD / CARTER DE VENTILATEUR / CARTER DEL VENTILATORE / CAPERUZA DE VENTILADOR
		89		912317 00000	ANSCHLUSS-SCHRAUBE / CONNECTION SCREW / VIS DE RACCORDEMENT / VITE DI RACCORDO / TORNILLO DE EMPALME
		94	012205 40500	012203 40500	LEITUNG / PIPE / TUYAU / CONDOTTO / CONDUCTO
		95	012206 40500	012204 40500	LEITUNG / PIPE / TUYAU / CONDOTTO / CONDUCTO
		97		068100 40300	STÜTZE / SUPPORT PILLAR / SUPPORT INTERMEDIAIRE / SUPPORTO / APOYO
		98		741310 80000	GUMMIPUFFER / RUBBER BUFFER / AMORTISSEUR EN CAOUTCHOUC / AMMORTIZZATORE IN GOMMA / AMORTIGUADOR DE GOMA
		99		945218 00000	SECHSKANTSCHRAUBE / HEX. HEAD SCREW / VIS HEXAGONALE / VITE ESAGONALE / TORNILLO HEXAGONAL
		141	960205 40300		KÜHLER / COOLER / REFROIDISSEUR / RAFREDDATORE / REFRIGERADOR
	146	948402 00000		HOHLSCHRAUBE / HOLLOW SCREW / VIS CREUSE / VITE ESAGONALE / TORNILLO HUECO	
	147	948030 00000		DICHTRING / GASKET / JOINT / GUARNIZIONE / JUNTA	

²⁾ variantenabhängige Bauteile / variant-dependent components / composants variante-dependantes / componenti variante-dipendenti / componentes variante-dependientes